

Roller Shade Installation Instructions

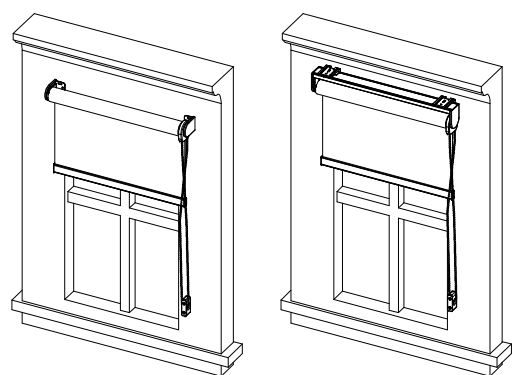

Roller Shade without Top Treatment

Roller Shade with Raceway

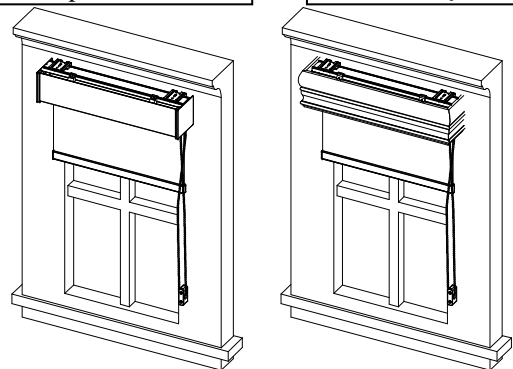

Roller Shade with Fascia

Roller Shade with Valance

Recommended Tools:

- Screw gun / drill
- Tape Measure
- Screwdriver
- Level
- Pencil



Hardware Included

1 Screws needed for installing:

Hardware	Drawing	Usage
1 1/4" Hexagon screw		Installing bracket
2" Flat head screw		Installing safety tension device
3/4" Round head screw		Installing hold down bracket

2 Roller shade without Top Treatment

Hardware	Drawing	Usage
Bracket for clutch		Installing shade (on Clutch end/ Tension Dial end /Motor end)
Bracket for end plug		Installing shade (on End Plug end)
Bracket cover		Default for Outside Mount & Inside-Top Mount
		Default for Inside-Side Mount
6mm Extension		Used for coupled shade
Link bracket		

Link rod		
Link bearing		
Link adapter		

3 Roller shade with Raceway System

Hardware	Drawing	Usage
Installation Bracket		Installing Raceway
7.6mm Extension		Used together with Installation Bracket
Valance Clip for Curved Fascia		Used for Curved Fascia and Valances
Valance Clip for Square Fascia		Used for Square Fascia
Square Fascia End Cap		Used for Square Fascia
Curved Fascia End Cap		Used for Curved Fascia
Valance return connector		Installing valance returns

Installation or Removal for Shades without top treatment:

1 Bracket Installation

For Inside-Top Mount & Side Mount:

- When installing brackets, the distance from the front mounting hole of the brackets to the front edge of window frame should be more than 3/4". Ensure both of the brackets are at the same horizontal line. Each bracket needs two 1 1/4" hexagon screws for installing.

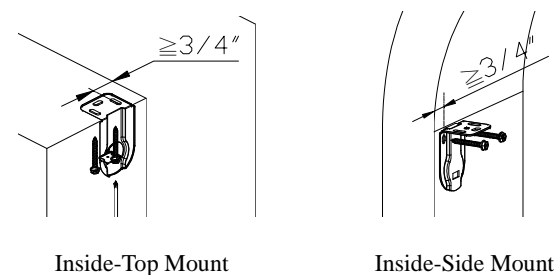

For Outside Mount:

- When installing brackets, the top of each bracket is parallel with the edge of the window frame. The distance from the mounting holes of the brackets to the front edge of the window frame should be more than 3/4". All brackets should be level and align. Each bracket needs two 1 1/4" hexagon screws.

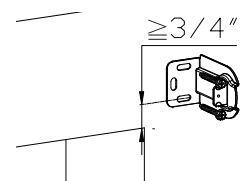

For Coupled Shade:

- Each bracket needs two 1 1/4" hexagon screws for installing. When installing the link bracket, make sure that the center of the link bracket and the left-right brackets are on the same level. As for the opening direction of Link bracket, it should be towards front for Inside Mount and towards up for Outside Mount. Coupled shades must need to install a 6mm Extension on the left and right brackets.

● Inside Mount

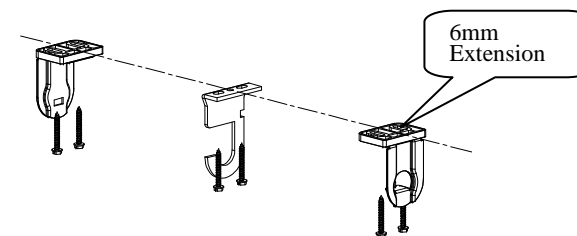

● Outside Mount

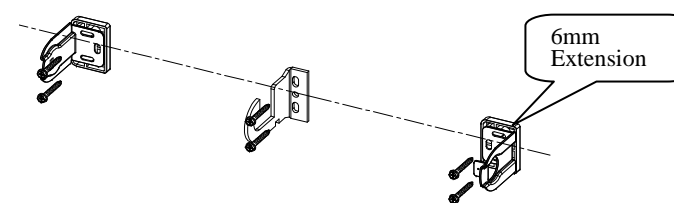

Bracket Installation tips:

①The top & bottom of left & right brackets should be at the same horizontal line.

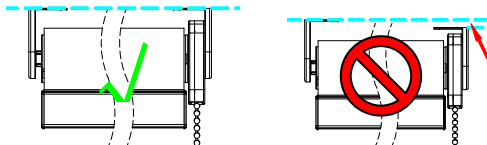

②The front & back of left & right brackets should be at the same horizontal line.

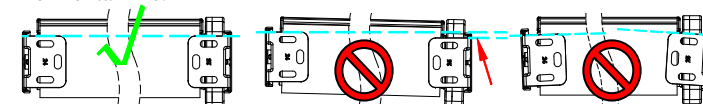

2 Shade Installation or Removal

● Installation

- ① First, insert the Clutch end/Motor end/Tension Dial end into the tongue of clutch bracket
- ② Second, press the End Plug and insert the End Plug end into the hole of bracket of the other side.
- ③ And then attach bracket covers to brackets. Finally remove paper band from shade. As shown below:

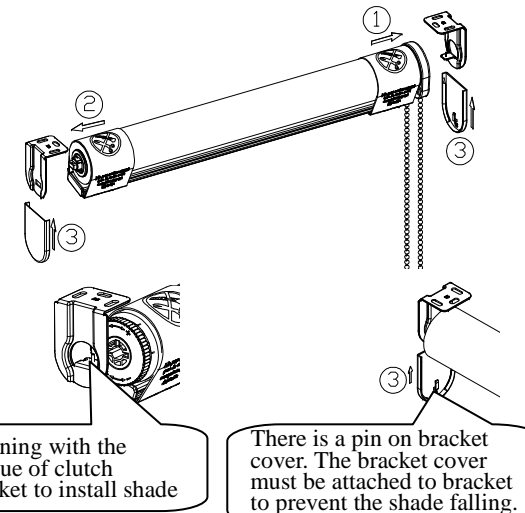

Aligning with the tongue of clutch bracket to install shade

There is a pin on bracket cover. The bracket cover must be attached to bracket to prevent the shade falling.

Shade Installation tips: After shade is installed into brackets, use a Level to check if the tube of shade is horizontal; if not, please adjust the position of brackets to keep the tube level.

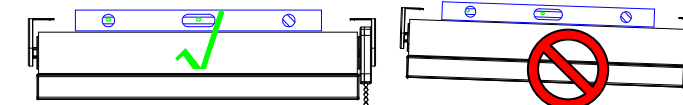

The tube of shade needs to be level

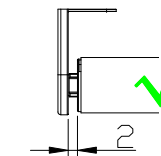

The gap from End Plug end to bracket needs to be about 2 mm.

● Removal

- ① First remove bracket cover from bracket on the End Plug end;
- ② Then Use a straight screwdriver to detach End Plug from bracket;
- ③ Finally remove Clutch end from the bracket of the other side.

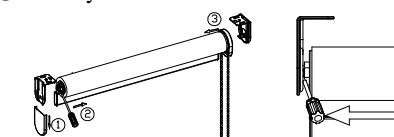

Installation for roller shade with Raceway system

- Below drawing is showing the position of Installation Bracket

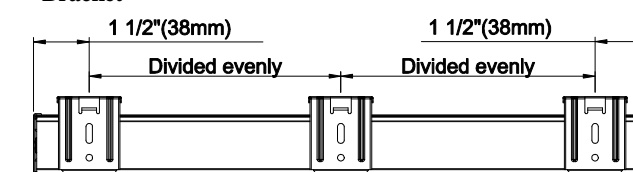

1 How to install Installation Bracket?

For Inside Mount:

- When installing the installation brackets, the distance from the front mounting hole of brackets to the front edge of window frame should be more than 3/4". Ensure all the installation brackets are at the same horizontal line. Each installation bracket needs two 1 1/4" hexagon screw for installing.

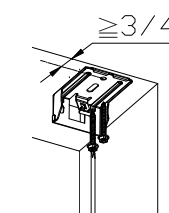

For Outside Mount:

- When installing the installation brackets, the top of each bracket is parallel with the edge of the window frame. The distance from the mounting holes of the brackets to the front edge of the window frame should be more than 3/4". Ensure all the installation brackets are at the same horizontal line. Each installation bracket needs two 1 1/4" hexagon screw for installing.

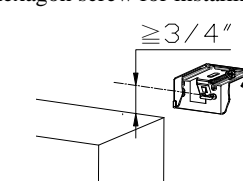

2 How to Install Shade with raceway into Installation Bracket:

If there is any fascia or valance, then it's necessary to attach valance clips into the front side of raceway first, and then install shade with raceway into installation bracket

- Hang the front of Raceway into the groove on the front of installation bracket;
- And then rotate shade upwards to make the back of Raceway clip into installation bracket. Ensure each installation bracket is clipped into groove firmly.

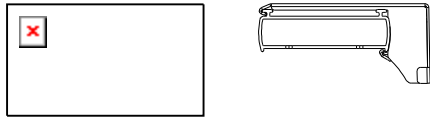

Note: After the shade is installed into the installation brackets, use a Level to check if the tube of shade is horizontal; if not, please adjust the position of brackets/installation brackets to keep the tube level.

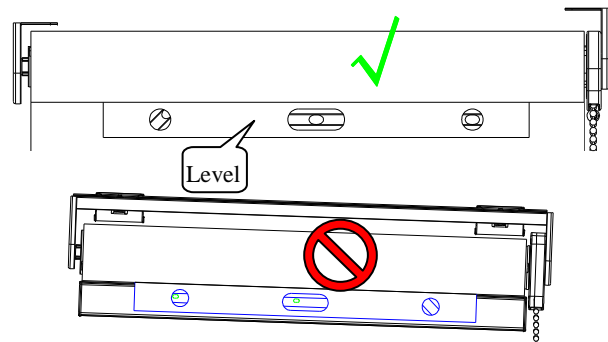

3 How to install Fascia and Valance:

- Attach valance clip into the front side of raceway first, and then install shade with raceway into installation bracket, and finally install Fascia / Valance. The installation for all Fascias & Valances is the same.

1. Attach valance clip into raceway:

Option 1:

- Put the bottom groove of valance clip against with raceway,
- Press top of valance clip to make the top groove clip into the raceway.

Option 2:

- Clip top groove into raceway;
- Press valance clip downwards slowly until it is attached to the raceway..

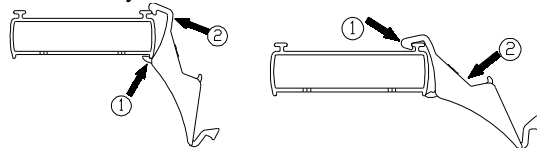

Option 1

Option 2

2. Fascia & Valance Installation (After the shade and valance clips are installed to installation brackets)

1) Fascia Installation:

Install Fascia end cap first, the left & right end caps for Square Fascia are the same, while the left & right end caps for Curved Fascia are different, which needs to be figured out when installing. The clips on fascia end cap should be aligned with Fascia, then attach it into fascia groove gently.

- Hang the top clip of Fascia to the top hook of valance clip;
- Turn the Fascia downwards to clip the bottom of Fascia into the valance clip.



Attach Fascia End Cap to Fascia

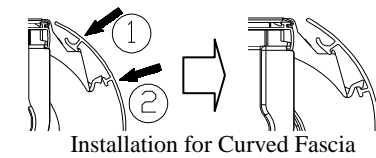

Installation for Curved Fascia

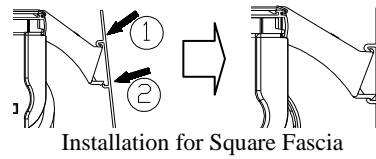

Installation for Square Fascia

2) Valance Installation:

- Connect valance and returns together if there are returns, then install them into valance clip.
- Hang the top hook of L shade Aluminum Strip which is at the back side of Valance to the top of valance clip.
- Then turn Valance downwards to make L shade Aluminum Strip attach to the valance clip. For IB, valances can be pushed directly into the valance clip by aligning the valance with the top of window frame.

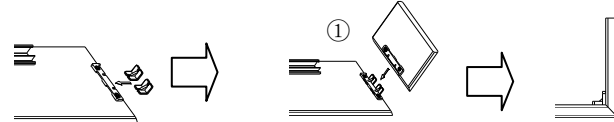

Attach returns to Valance

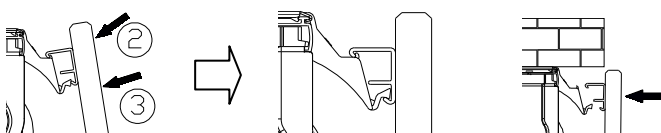

Dual Shade Installation

- The installation for Mounting Brackets & Raceway is same as Single shade.
- Please refer to "Valance Installation" to install valance.
- After installing dual shades and removing paper band from shades, please retrace Hem Bar of front shade by half -turn to make it align with the Hem Bar of back shade(as shown below).

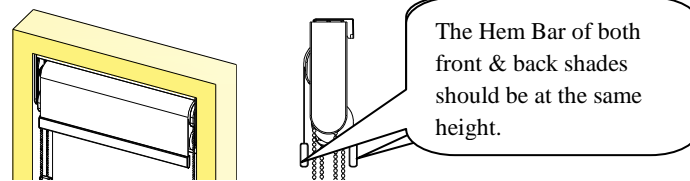
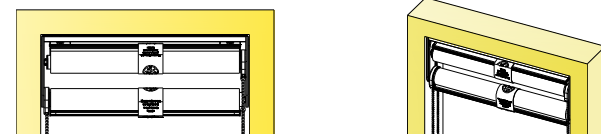

Removal for Roller Shade with Raceway system:

● Removal

- Remove Fascia & Valance: ① Press the bottom of valance clip with straight screwdriver to release the hook of fascia from the bottom of valance clip. ② And then push fascia & valance upwards and remove the top of fascia from valance clips, finally take down Fascia & Valance.

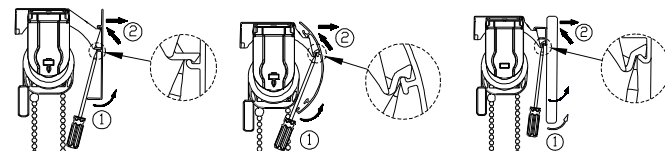

- Remove raceway & shade: ① Use a screwdriver to press back clip of installation bracket to take it off from bottom clip of Raceway. ②

Turn over Raceway to take it off from installation bracket. ③Take it off from front clip of installation bracket, then take off shade from it.

Note: If there is not enough room to insert a screwdriver into Raceway, please lower the shade a bit to make enough gaps between Raceway and Tube and then remove shade. Due to resilience of Installation Bracket, it is needed to seize the Tube outward to prevent clip of Installation Bracket rebounding into raceway after the clip is detached from Raceway. Otherwise, it will fail to remove the shade.

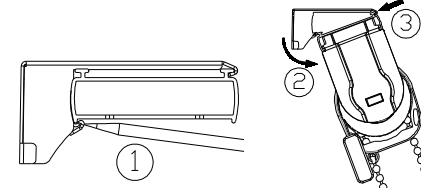

Install Safety Tension Device:

- The chain should be fully extended when attaching the safety device.
- Attach safety device needs 2 pieces 2" flat screws.

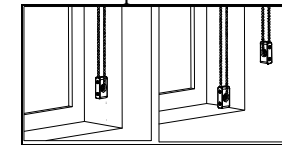

Battery Wand Installation:

- Battery wand can be installed horizontally or vertically. First remove battery wand clips from the battery wand and then fix these two clips to the wall in a vertical line, and finally attach the battery wand to clips.
- Load batteries into battery wand and snap the battery wand into clips.
- After both the shade and battery wand are installed, connect the power cord of the motor and the battery wand.

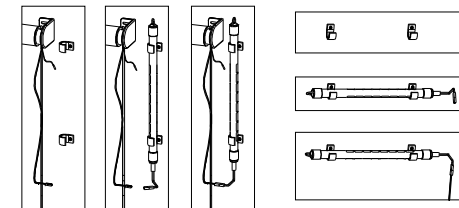

Roller Shade Operation:

Operation for Continuous Cord Loop:

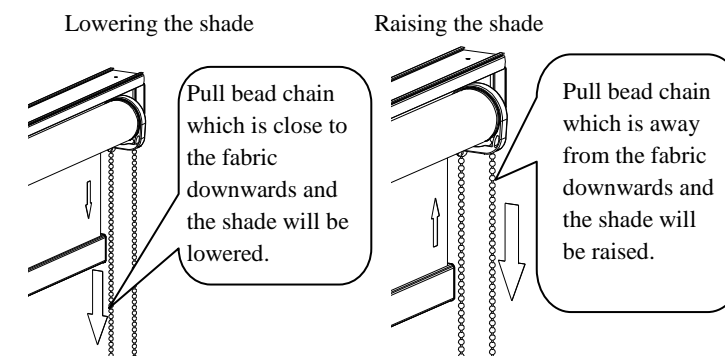

Operation for Continuous Cord Loop with Smart Release System:

A Lowering the shade:

- Gently pull the bead chain which is close to the fabric and the shade will lower automatically.
- If need to stop the shade during lowering, please pull the bead chain which is away from the fabric and then the shade will stop.
- If the shade cannot lower automatically when gently pull the bead

chain which is close to the fabric, please pull the bead chain which is away from the fabric first, and then pull bead chain on the other side.

B Raising the shade:

- Pull bead chain which is away from the fabric downwards to raise the shade.

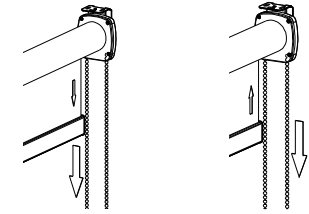

Operation for Cordless Roller Shade:

A Lowering the shade:

- Hold the handle of cordless roller shade and pull the shade down until it stops.
- Normally, the handle of cordless roller shade will be on the back of the hem bar.
- When shade is installed in high position, the wand with a hook can be used to reach the handle and pull the shade down.

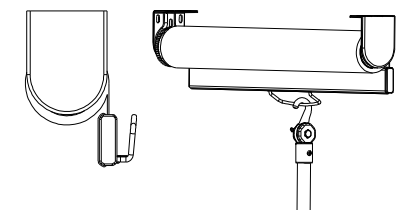

B Raising the shade:

- Please note that the speed for shade to roll up cannot be too fast.
- To roll up the shade, pull the handle downward a little to release shade from locked state. Make sure shade fabric keep vertical when rolling up, do not incline or twist, otherwise the shade will have telescoping (tracking) issues. Finally release the handle and then the shade will roll up automatically.

Tension (Speed) Adjustment for Cordless roller shade:

- Generally, there is no need to adjust the speed of a new roller shade. Adjustment is needed when shade fails to roll up, rolls up too slowly or rolls up too fast.
- When the shade fails to roll up or rolls up too slowly, rotate the Tension Dial clockwise (along the arrow) to increase the spring tension (as shown below). If shade rolls up too fast, rotate the Tension Dial counter-clockwise to decrease the spring tension, the rolling speed can be adjusted as needed.

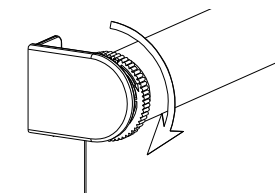

Attention

Shade is heavy. Be careful during installation.