

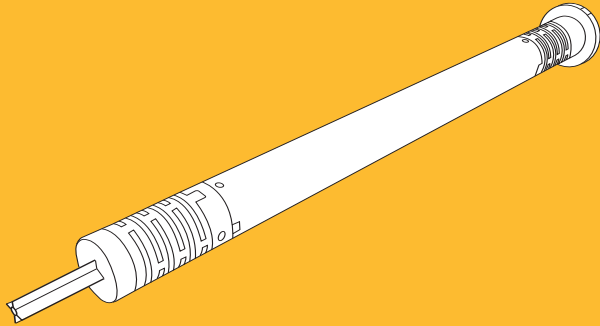

Installation guide

Sonesse 30 RTS



Ref. 5 047 194



Australia: SOMFY PTY LTD
www.somfy.com.au

Austria: SOMFY GmbH
www.somfy.at

Belgium: SOMFY Belux
www.somfy.be

Brasil: SOMFY Brasil LTDA
www.somfy.com

Canada: SOMFY ULC
www.somfy.fr

Cyprus: SOMFY Middle-East CO LTD
www.somfy.com

Czech Republic: SOMFY Spol s.r.o.
www.somfy.cz

Denmark: SOMFY Denmark
www.somfy.se

Finland: SOMFY Finland
www.somfy.fi

France: SOMFY France
www.somfy.fr

Germany: Somfy GmbH
www.somfy.de

Greece: SOMFY Hellas SA
www.somfy.com

Hong-Kong: SOMFY Co. Ltd
www.somfy.com

Hungary: SOMFY kft
www.somfy.hu

India: SOMFY India PVT Ltd
www.somfy.com

Italy: SOMFY Italia S.R.L.
www.somfy.it

Japan: SOMFY KK
www.somfy.co.jp

Lebanon: SOMFY Middle East
www.somfy.com

Mexico: SOMFY Mexico SA de CV
www.somfy.com.mx

Morocco: SOMFY Maroc
www.somfy.com

Netherlands: SOMFY BV
www.somfy.nl

Norway: SOMFY Norway
www.somfy.se

Poland: SOMFY SP Z.O.O.
www.somfy.pl

Portugal: SOMFY Portugal
www.somfy.com

Russia: SOMFY LLC
www.somfy.ru

Singapore: SOMFY PTE LTD
www.somfy.com

Slovakia: SOMFY Spol s.r.o.
www.somfy.sk

South Korea: SOMFY JOO
www.somfy.co.kr

Spain: SOMFY Espana SA
www.somfy.com

Sweden: SOMFY Nordic AB
www.somfy.se

Switzerland: SOMFY A.G.
www.somfy.ch

Taiwan: S2C SA TAIWAN BRANCH OFFICE
www.somfy.com

United Kingdom: SOMFY LTD
www.somfy.co.uk

United States: SOMFY Systems Inc
www.somfysystems.com

The failure to respect these instructions annuls Somfy's responsibility and guarantee. Somfy cannot be held responsible for any changes in norms and standards introduced after the publication of this guide.

A CHARACTERISTIC

B INSTALLATION & WIRING

[1]. Caution

[2]. Tube preparation

[3]. Motor mounting

a. Mounting with Drive Kit.

b. Mounting with LS40 Adapter Accessory kit.

[4]. Install the motor in the tube

[5]. Install the tube on the brackets

a. Use self-tapping screw M4.

b. l: Working length (6 mm max)

L: length L depend of the accessory or bracket.

c. LS40

d. Rollease

e. Adapter Bracket

[6]. Power Supply & Wiring

If there is a wrong connection during the installation, the motor doesn't work. Use GPS100.

A

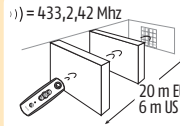
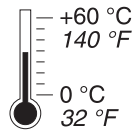

24V DC SELV



B

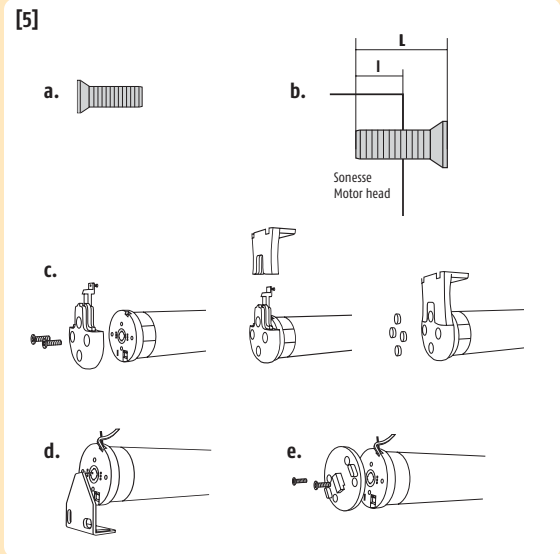
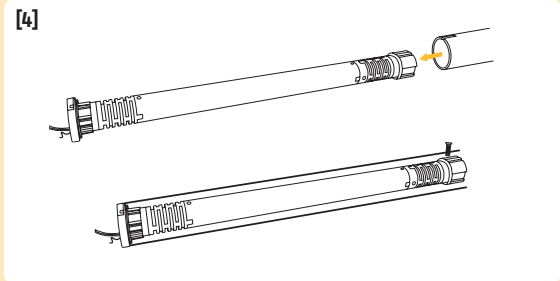
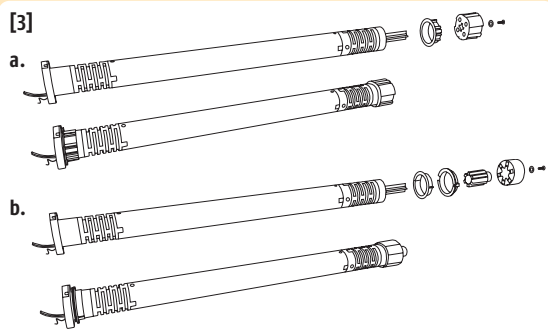
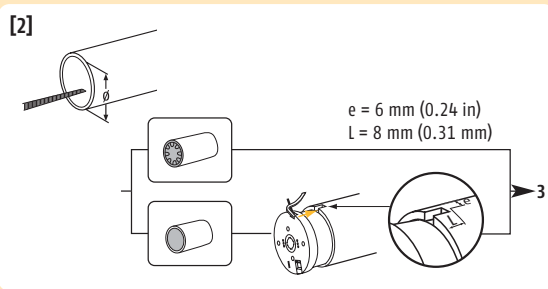
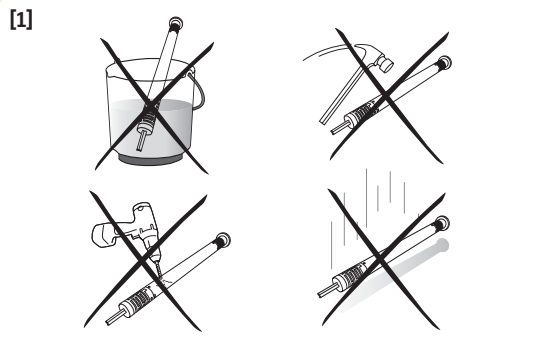

C PROGRAMMING

Connect power to motor

[1]. Assign a transmitter

For multi-channel transmitters, select the desired channel. Press and hold the UP and DOWN buttons simultaneously until the motor jogs. The transmitter address is temporarily record.

[2]. Check polarity

If the direction is wrong, press the MY button for 2 seconds until the motor jogs.

[3]. End limit adjustment

- Press the UP button to move the shade to the UP position.
- Press the MY and DOWN buttons and release them once the motor begins to move. The UP LIMIT is memorized.
- Press MY button when it reaches the desired down position.
- If necessary adjust the down position using the UP and DOWN buttons.
- Press the MY and UP buttons and release them once the motor begins to move. The motor moves up and will stop at its UP LIMIT or you could stop it by pressing the MY button.
- To confirm the ends limits press the MY button for 2 seconds until the motor jogs.
- Press the programming button on the back of the RTS transmitter until the motor jogs. The transmitter address is permanently record.

[4]. Adding or deleting additional transmitters

- With a remote control:
Press 2s the program button on the previously programmed transmitter until the motor jogs. Press the program button of the additional transmitter until the motor jogs. The additional transmitter is recorded or deleted.
- With the Sonesse prog button:
Press 2s on the Sonesse prog button until the motor jogs. Press 2s the program button of the transmitter until the motor jogs. The additional transmitter is recorded or deleted.

To erase all the transmitters recorded on the Sonesse motor press 7s on the Sonesse prog button until the motor jogs 2 time. The first at 2s and the second at 7s.

[5]. Intermediate position

- To set the intermediate position, move the shade to the desired position with the UP and DOWN button. After press the MY button for 5 seconds until the motor jogs.
- To delete the intermediate position, move to this position and press the MY button for 5 seconds until the motor jogs.
- To readjust the intermediate position, move to the new intermediate position and press the MY button for 5 seconds until the motor jogs.
- To move the shade to the intermediate position, press briefly the MY button.

[6]. Readjusting the limits

- Press the UP or DOWN button, to move the shade to the limit to be readjusted.
- Press and hold the UP and DOWN buttons simultaneously for 5 seconds until the motor jogs.
- Press and hold the UP or DOWN button to move the shade to the new desired position.
- To confirm the new limits press the MY button for 2 seconds until the motor jogs or press again UP and DOWN button simultaneously to exit without any end-limit changes.

[7]. Factory reset

With the Sonesse prog button
Press 12s on the Sonesse prog button until the motor jogs 3 times. The first at 2s, the second at 7s and the third at 12s.

[8]. Manual operation

Press the man set button and the motor will move in the opposite direction from the last movement. Press this button again to stop the motor.

C

[1]

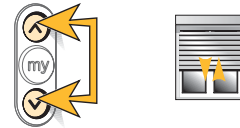

[2]

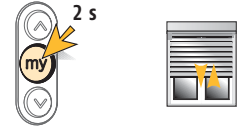

[3]

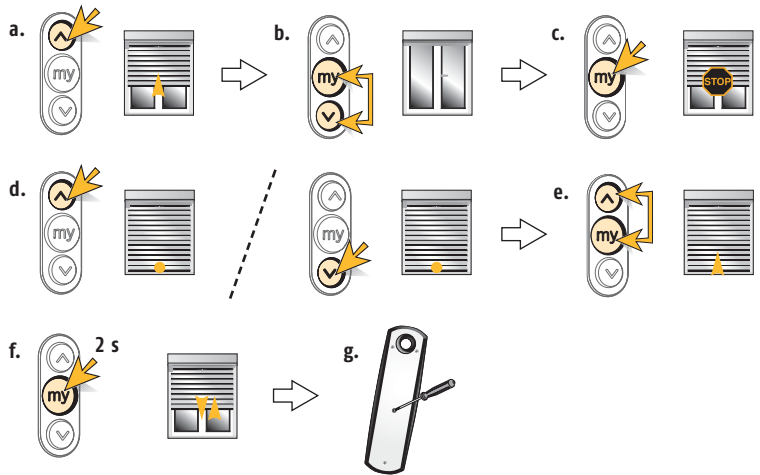

[4]

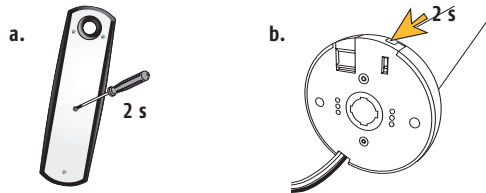

[5]

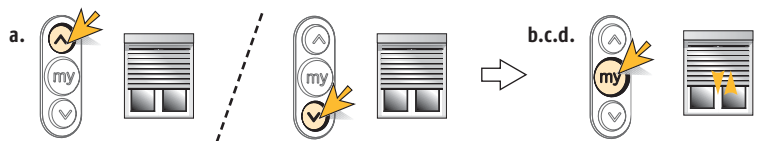

[6]

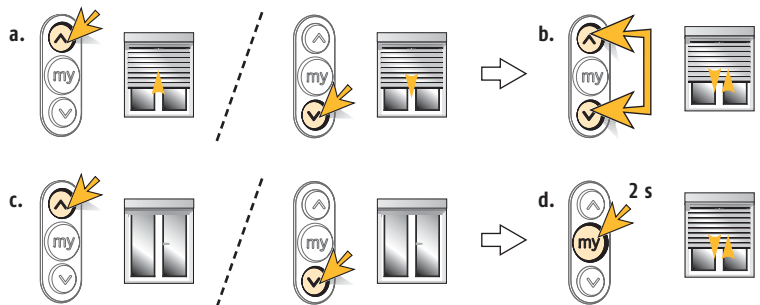

[7]

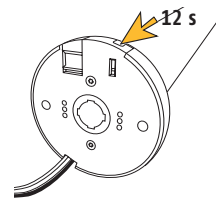

[8]

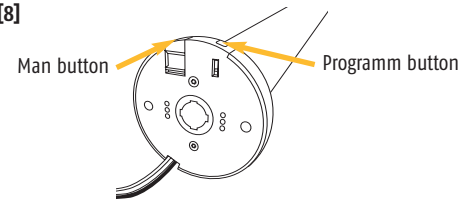

D TROUBLE SHOOTING

The motors doesn't work

- Verify:
- The wiring of motor (+/-)
 - The battery of the remote control
 - The compatibility of the remote control

The equipment stops to soon

- Verify:
- The end-limits of the motor are properly adjusted